

Carefully cut out the shapes on this page. Use a hobby knife to slit the white lines. Tape and glue are not necessary. Thicker paper is recommended.

RIGHT ARM

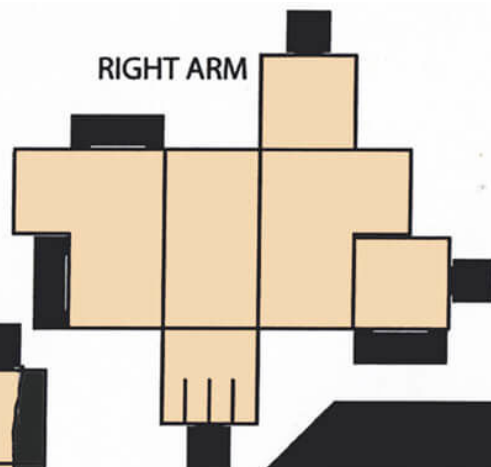

LEGS

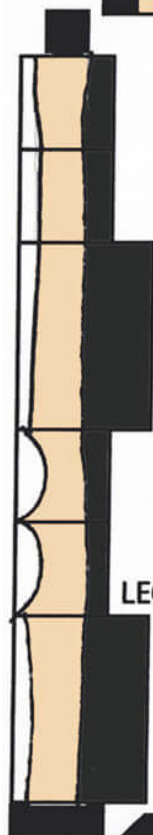

For more Cubee Designs, go to:
theflyingdachshund.deviantart.com
 or
theflyingdachshund.blogspot.com

template design © 2007
 Chris Beaumont
 cubecraft@gmail.com
 Awesome toy design by:
 Josh Wolf

TORSO



LEFT ARM

contact: cubecraft@gmail.com